



COMPLETE
YOUR NEW
HOME WITH
THIS GREAT
OFFER

A FREE \$5,000 front garden landscaping package

offered by Shannon Waters Estate

Shannon Waters Estate is committed to delivering a high quality residential community.

So, by taking the effort and expense out of landscaping your front garden, you can live and breathe a little easier at Shannon Waters Estate and enjoy your new life here.

Up front & personal

A great neighbourhood creates connections between neighbours, the land and the community around it.

Shannon Waters Estate has been carefully designed to deliver high standards of building design, landscaping and maintenance, with a strong commitment to the surrounding environment.

Buying land and building a new home is a big investment we know.

To help you Shannon Waters Estate are offering a **FREE \$5,000 Landscaping Package** for your front garden.

We know this will enhance your lifestyle and the surrounding neighbourhood at Shannon Waters Estate.



Traditional

*Clean stylish look to complement your home, adding interest and is low maintenance.**



THE FREE \$5000 LANDSCAPE PACKAGE STANDARD INCLUSIONS ARE:-

Letterbox

Concrete steppers

Imported quality topsoil

Timber edging

A range of quality plants

Varying mulch and/or stone aggregates

The flexibility to work with our qualified accredited landscaping contractor, Grow Master Landscaping, to design the look you want

Grow Master is a member of Irrigation Australia

Prompt installation of your garden by our friendly and reliable contractor

Opportunity to 'upgrade' your package is available at your own cost

The Process



1

Meet with King & Heath to purchase your new home site at Shannon Waters Estate.



2

Read your Land Sales Contract which will contain your agreed details of this offer.

Offer price based on Traditional garden design. Variations or changes may incur additional costs. For terms and conditions, please talk to King & Heath First National.

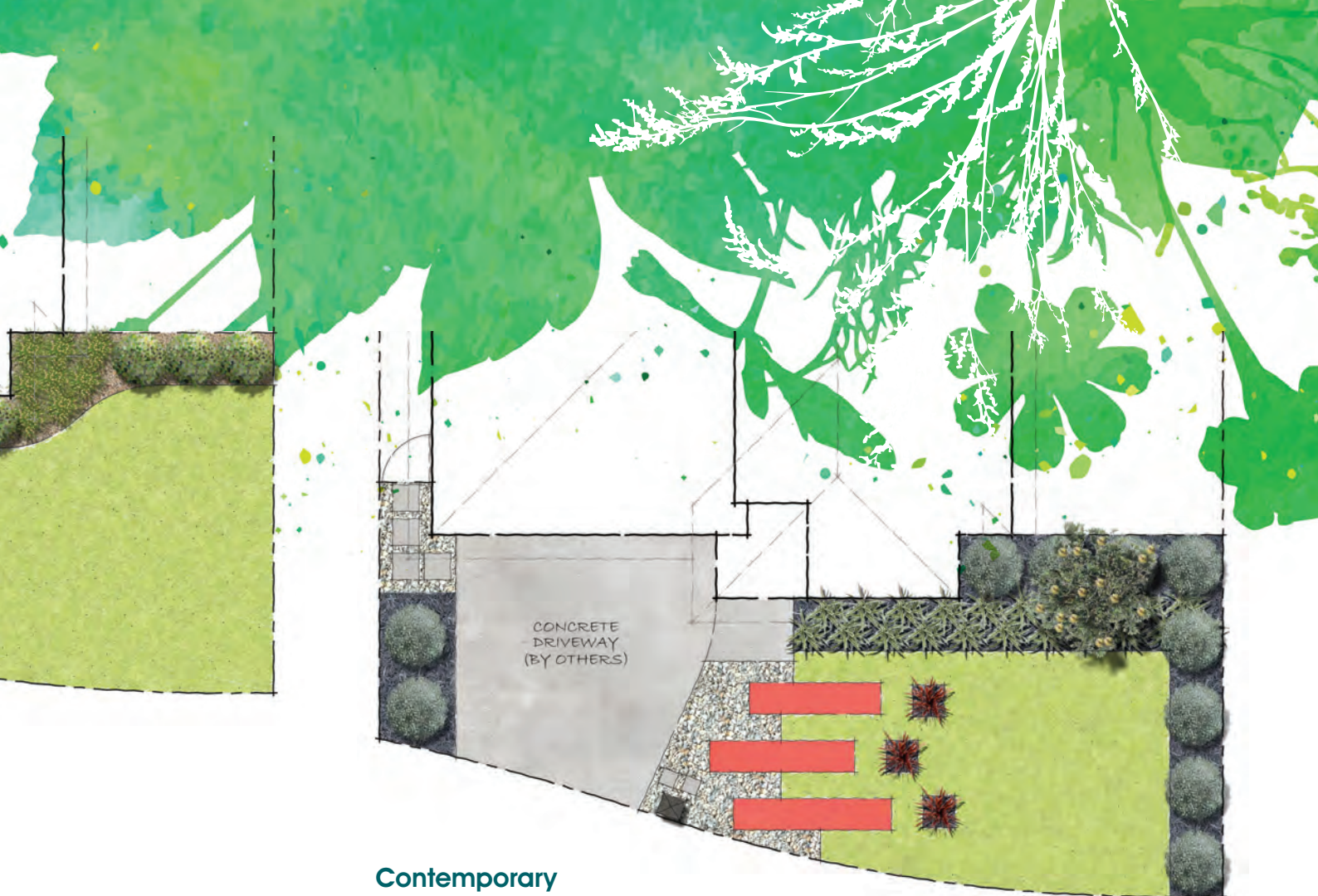

Contemporary

*A variety of textural detail creating a sophisticated garden to enhance your home.**



Choose
your home style
from one of our
quality builders.

Submit a copy of your
builders site plan to Grow
Master Landscaping,
once your home style
has been decided.

**Meet with Grow Master
Landscaping** to discuss
the unique look and
features of your front
garden and resolve
any 'extras' you may
want. Grow Master
Landscaping will finalise
a quote, advising of
any additional cost
you may have.

Once your home
is completed, and
you're ready for the
landscaping to be
installed, make contact
with Grow Master
Landscaping and
arrange a time.

*You may have to pay
a deposit at this time for
any additional upgrades
requested.*

Upon satisfactory
completion of the
works all you need to
do is pay Grow Master
Landscaping any
difference, and the
Shannon Waters Estate
Management will look
after the rest.



King & Heath

Phone 03 5152 3311

ShannonWatersEstate

www.shannonwatersestate.com.au

Disclaimer: This document has been prepared based on information available at the time of this publication. No responsibility or warranty, express or implied, is made as to the fairness, accuracy, completeness or correctness of the information, opinions and conclusions contained within. To the maximum extent permitted by law, none of the Vendor, its related bodies corporate or any of its directors, employees, agents or advisers accept any liability for any loss arising from the use of this document or its contents or otherwise arising in connection with it, including, without limitation, any liability arising from fault or negligence on the part of the Vendor, its related bodies corporate or any of its directors, employees, agents or advisers.

Nothing in this document is a promise or representation as to the future. Statements or assumptions in this document as to future matters may prove to be incorrect and the differences may be material. None of the Vendor, its related bodies corporate or any of its directors, employees, agents or advisers gives any representation or warranty as to the accuracy of such statements or assumption.